

User Guide

Air Pump Diagram

Function keys:

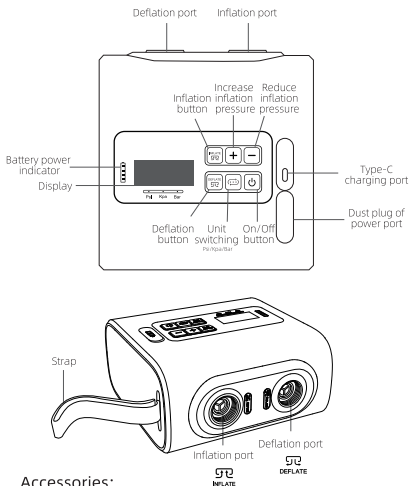

Accessories:

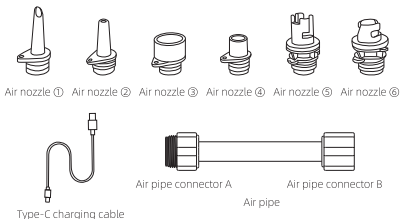

The product, accessories and other illustrations in the manual are schematic diagrams for reference only. The actual product shall prevail.

Diagrams

Inflation:

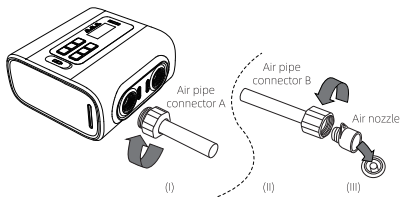

- 01 Connect the air pipe:
Connect "Air pipe connector A" with the "Inflation port" (INFLATE) of the air pump, and rotate to fasten them (I), select a suitable air nozzle, connect it with the "Air pipe connector B", and rotate to fasten them (II), and insert the air nozzle into the inflation valve of the product to be inflated, and fasten it (III).
- 02 Double click on the "On/Off button", and the display screen will light up.
- 03 Press the "Unit switching" button to select the unit of "Psi, Kpa or Bar".
- 04 Press the "+" or "-" button to set the desired inflation pressure value.
- 05 After completing the above steps, press the "Inflation button" to start inflating.
- 06 During inflation, one can press the "Inflation button" or the "On/Off button" to stop inflation.
- 07 When the inflation pressure reaches the set pressure value, the air pump will automatically stop working.
- 08 After completing the inflation, press the "On/Off button" to turn off the air pump, and the display screen will disappear.

Deflation instructions

Deflation:

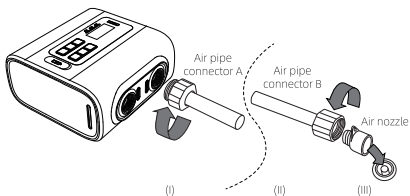

01 Connect the air pipe:

Connect "Air pipe connector A" with the "Deflation port" (DEFLATE icon) of the air pump, and rotate to fasten them (I), select a suitable air nozzle, connect it with the "Air pipe connector B", and rotate to fasten them (II), and insert the air nozzle into the deflation valve of the product to be deflated, and fasten it (III).

02 Double click on the "On/Off button", and the display screen will light up.

03 Press the "Deflation button" to start deflating.

04 please notice the progress of suction when it is going on.

05 After completing the deflation, press the "On/Off button" to turn off the air pump, and the display screen will disappear.

Charging instructions

Battery charging

- 01 The device has a built-in rechargeable lithium-ion battery, which provides power for the air pump, and can be charged through the Type-C charging port.
- 02 Connect the provided Type-C charging cable to the power adapter to start charging. During charging, you can check the charging progress through the four battery indicator lights.

Charging voltage: 5V  2A

A power adapter that meets the GB4706.1-2005 standard shall be used.

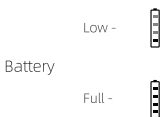

Ensure that the air pump is fully charged at least once a month to avoid battery life decay or damage.

Precautions

01. The air pump is not a toy. Please do not let children approach or come into contact with this product during use. Please keep this product out of reach of children.
02. Do not use the air pump continuously for more than 20 minutes. Let it cool for at least 10 minutes before reuse, otherwise the motor may overheat, resulting in damage.
03. Before using the air pump, please conduct necessary inspections. If any abnormalities are found, please do not use it.
04. If any foreign objects or high temperatures are found during inflation, please stop using it immediately.
05. Please do not leave during inflation for fear of accidents.
06. At any time, please ensure that the inflation and deflation ports of the air pump are not blocked.
07. Do not allow water or foreign objects to enter the inflation and deflation ports.
08. Do not use strong chemicals, cleaning agents or other chemicals during cleaning.
09. Do not store the air pump in a place that is excessively cold, hot or wet. Store it in a dry place.
10. Do not use the charger in a damp place. Do not plug or unplug the charger with wet hands.
11. Please dispose of this product, its battery and other accessories according to local regulations instead of disposing of them as household wastes. Improper disposal of the battery may cause fire.
12. No specific air pump maintenance is required. The air pump has no parts that can be repaired or replaced by the user.
13. If the air pump is to be left unused for a long time, please fully charge it before storage and ensure that it is fully charged at least once a month to avoid battery life decay or damage.

Troubleshooting

If the air pump fails to work well:

01. Please check whether there is water or other liquid on the surface of the air pump.
02. Please check whether the battery power is sufficient.
03. Please check whether the power switch is turned on.